

# KENWOOD

## ***For the Users of the HM-682MD***

Model HM-682MD is a special version of the HM-582MD. For the installation, connection, operation and other instructions, refer to the HM-582MD INSTRUCTION MANUAL. This booklet pertains only to the functions proper to the HM-682MD.

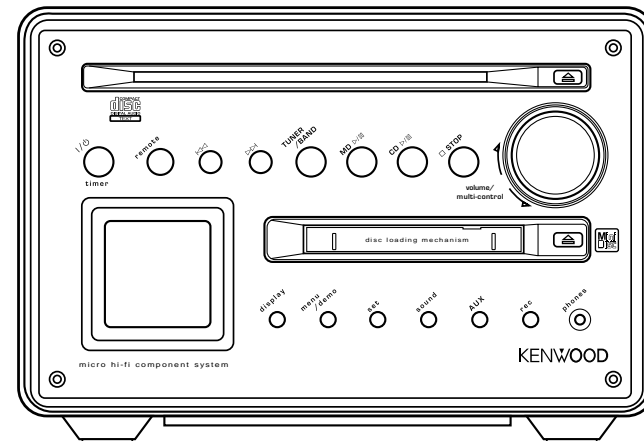

**HM-682MD**  
**Main unit**

### ***Special features***

#### ***Frosty cover with interior design considerations***

The main unit is provided with a removable cover. The cover does not only protect the system from damage and dirt but also suits the interior of many listening rooms.

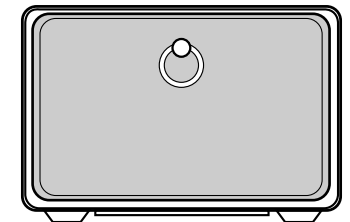

---

# KENWOOD

#### ***For your records***

Record the serial number, found on the back of the unit, in the spaces designated on the warranty card, and in the space provided below. Refer to the model and serial numbers whenever you call upon your dealer for information or service on this product.

Model \_\_\_\_\_ Serial Number \_\_\_\_\_



B60-4825-00 00 (CH) (T) AP 0005

## Front cover

### Removing the front cover

- ÷ Pull the ring-shaped handle to remove the front cover.

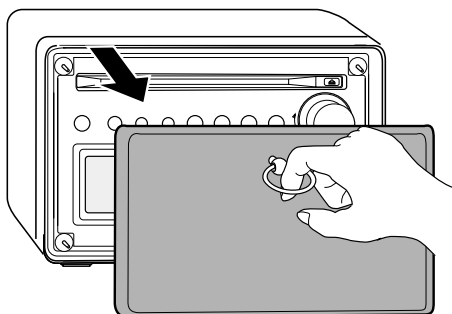

### Attaching the front cover

- ÷ Align the projections on the top edge of the main unit with the holes on the back of the front cover, and push in gently to attach the front cover to the main unit.

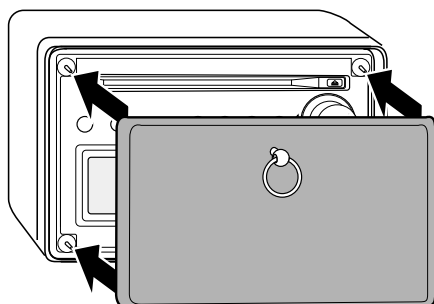

## Specifications

### Main unit

#### [Amplifier section]

Rated output power during STEREO operation  
1 kHz, 1.0 % T.H.D., at 6 Ω ..... 15 W + 15 W  
Effective output power during STEREO operation  
1 kHz, 10 % T.H.D., at 6 Ω ..... 20 W + 20 W  
Frequency response  
AUX ..... 50 Hz~50 kHz (0 dB ~ -3dB)

#### [Tuner section]

FM tuner section  
Tuning frequency range ..... 87.5 MHz ~ 108 MHz  
MW (AM) tuner section  
Tuning frequency range ..... 531 kHz ~ 1,602 kHz

#### [MD recorder section]

Laser wave length ..... 765 to 805 nm  
Laser power class ..... Class 3A  
Laser ..... Semiconductor laser  
Recording method .... Field modulation overwrite method  
Audio compression  
ATRAC (Adaptive TRansform Acoustic Coding)  
D/A Conversion ..... 1 Bit  
Wow & flutter ..... Less than unmeasurable limit

#### [CD player section]

Laser wave length ..... 760 to 800 nm  
Laser power class ..... Class 3A  
Laser ..... Semiconductor laser  
D/A Conversion ..... 1 Bit  
Oversampling ..... 8 fs (352.8 kHz)  
Frequency response ..... 20 Hz~20 kHz, ± 1 dB  
Wow and flutter .... Less than unmeasurable limit

#### [General]

Power consumption ..... 60 W

#### Dimensions

##### (Horizontal installation)

..... W : 220 mm (8-11/16")  
H : 150 mm (5-7/8")  
D : 368 mm (14-1/2")

##### (Vertical installation)

..... W : 142 mm (5-9/16")  
H : 228 mm (9")  
D : 368 mm (14-1/2")

Weight (net) ..... 6 kg (13.2 lb)

### Speakers

Enclosure ..... BASS RE-FREX type

#### Speaker configuration

Woofer ..... 100 mm, cone type  
Tweeter ..... 19 mm, dome type

Impedance ..... 6 Ω

Maximum input level ..... 30 W

#### Dimensions

##### (Horizontal installation)

..... W : 220 mm (8-11/16")  
H : 150 mm (5-7/8")  
D : 252 mm (9-15/16")

##### (Vertical installation)

..... W : 142 mm (5-9/16")  
H : 228 mm (9")  
D : 252 mm (9-15/16")

Weight (net) ..... 2.8 kg (6.2 lb) (1 piece)



KENWOOD follows a policy of continuous advancements in development. For this reason specifications may be changed without notice.

+ Sufficient performance may not be exhibited at extremely cold locations (where water freezes).